



02/20/2019

800 STEWART

ADDRESS:
800 STEWART STREET
SEATTLE, WA 98101

OWNER: 800 STEWART, LLC

LEGAL DESCRIPTION: LOTS 1 AND 2, BLOCK 26, SECOND ADDITION TO THE TOWN OF SEATTLE, AS LAID OFF BY THE HEIRS OF SARAH A. BELL, DECEASED, COMMONLY KNOWN AS HEIRS OF SARAH A. BELL'S SECOND ADDITION TO THE CITY OF SEATTLE, ACCORDING TO THE PLAT THEREOF RECORDED IN VOLUME 1 OF PLATS, PAGE 121, RECORDS OF KING COUNTY, WASHINGTON.

EXCEPT THE SOUTHEASTERLY 7 FEET OF SAID LOT 1 CONDEMNED IN KING COUNTY SUPERIOR COURT CAUSES NO. 58229 FOR THE WIDENING OF STEWART STREET AS PROVIDED BY ORDINANCE NO. 14881 OF THE CITY OF SEATTLE.

TOGETHER WITH AND SUBJECT TO EASEMENTS, COVENANTS AND RESTRICTIONS OF RECORD.

KING COUNTY ASSESSOR PARCEL NO:
066000-0625
KING COUNTY RECORDING NUMBER:
20110622900003

SITE PLAN

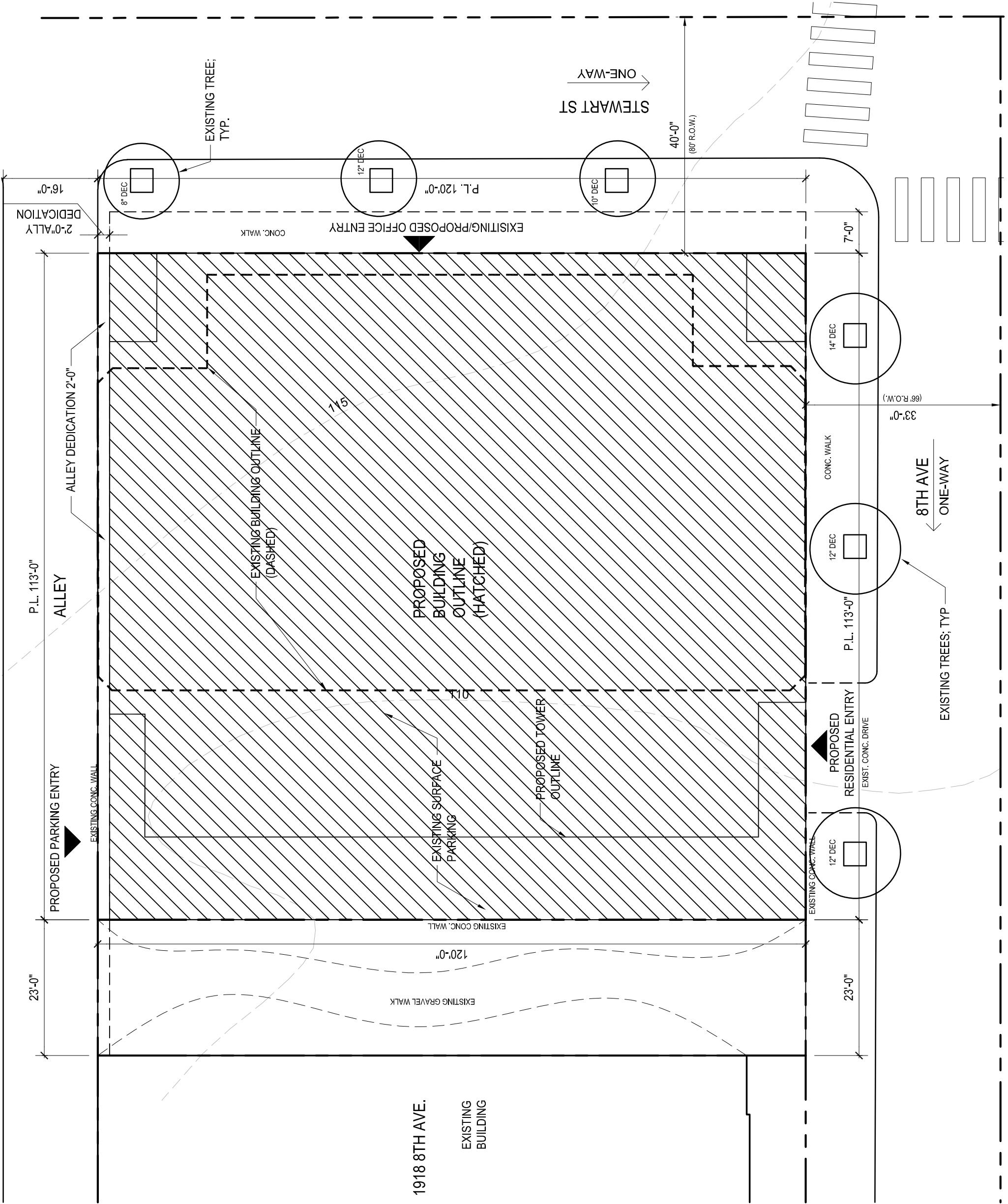
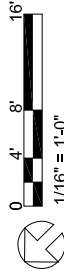

16'-0" DEDICATION
2'-0" ALLEY
16'-0" DEDICATION
2'-0" ALLEY
ALLEY DEDICATION 2'-0"
ALLEY
P.L. 113'-0"
PROPOSED PARKING ENTRY
EXISTING CONC. WALL
EXISTING GRAVEL WALK
120'-0"
EXISTING CONC. WALL
EXISTING CONC. WALL
EXISTING SURFACE
EXISTING PARKING
PROPOSED TOWER OUTLINE
PROPOSED BUILDING OUTLINE (HATCHED)
EXISTING BUILDING OUTLINE (DASHED)
EXISTING TREE; TYP.
12" DEC
12" DEC
10" DEC
40'-0" (80' R.O.W.)
STEWART ST
ONE-WAY
7'-0"
14" DEC
CONC. WALK
33'-0" (66' R.O.W.)
8TH AVE
ONE-WAY
EXISTING TREES; TYP.
P.L. 113'-0"
12" DEC
12" DEC
PROPOSED RESIDENTIAL ENTRY
EXIST. CONC. DRIVE
23'-0"
23'-0"